

PI-PV500W Cable Controller Operational Manual

1. Place the PV-500 on a flat surface with the SD card slot on the left hand side, and the IR sensor pointing toward you, as shown in illustration 1.



2. GENTLY plug the Mini USB connector into the Control port on the PV-500 with controller cable pointing to the right hand side, as shown in illustration 2.



3. Connect a camera to the A/V-in socket on the PV-500 and slide the Stop/Rec switch to record position, both are on the right hand side of PV-500, as shown in illustration 3.

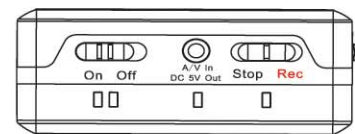

4. When the cable controller is properly attached to the PV-500, you can power on/off the unit simply by sliding the spring switch on the other end of the cable.

5. Slide the spring switch on the end of cable controller for about two seconds then the system will automatically power on and enter to record mode. An indicator LED on the top of the switch will be on.

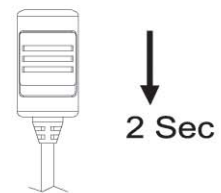

6. To stop a video recording in operation, slide the switch on cable controller and hold for two to four seconds then release the switch, the system will automatically shut down and save the video file. The indicator LED will be off.

